

Shock sensor

DIX SAS 100



Shock sensor with adapter flange

Technical data:

Shock sensor

Reset accuracy: ± 0.03 mm
(400 mm to robotic flange)

Deflection range: 20°

Switch class: Opener

Switching capacity: 30V DC/0.5A

Dimension (D/H): $\varnothing 78.5 / 65$ mm

Weight: 640 g

Cable length: 100-850 mm

Adapter flange **DIX ADF 6xxx**
(Bore pattern dependent of robot type)

Technical benefits:

- Crash-protection of robot, welding torch and welding fixture at collision in set up and automatic mode
- Quick switch off the robot through program stop or emergency stop
- Precise reset after deflection
- Low weight

Application:

- For DINSE torch systems
gas cooled
DIX MET / METT 310
liquid cooled
DIX METZ / METTZ 600



MIG/MAG - torch system, separable and torch bracket, wippe (application sample)



TIG - torch system, separable and torch bracket, fixed (application sample)

Shock sensor

DIX SAS 200



Shock sensor with adapter flange

Technical data:

Shock sensor

Reset accuracy:	± 0.03 mm
(400 mm to robotic flange)	
Deflection range:	20°
Switch class:	Opener
Switching capacity:	30V DC/0.5A
Dimension (D/H):	ø 78.5 / 65 mm
Weight:	640 g
Cable length:	100-850 mm
Adapter flange	DIX ADF 6xxx
(Bore pattern dependent of robot type)	

Technical benefits:

- Crash-protection of robot, welding torch and welding fixture at collision in set up and automatic mode
- Quick switch off the robot through program stop or emergency stop
- Precise reset after deflection
- Low weight

Application:

- For DINSE torch systems
 - gas cooled**
 - DIX MEPTT 310
 - liquid cooled**
 - DIX MEPTTZ 600
 - DIX DTS 500 (P)



MIG/MAG - torch system, double separable and torch bracket, PUSH-PUSH/PUSH-PULL (application sample)



WIG - torch system, double separable and torch bracket, PUSH-PUSH/PUSH-PULL (application sample)

Shock sensor

DIX SAS 100
DIX SAS 200



Pos.	Description	Dimension	Part number	Article number
1	Shock sensor	ø 78.5 / 65 mm	DIX SAS100	683100001
2	Shock sensor	ø 78.5 / 65 mm	DIX SAS200	683100200

Spare parts and wear parts

3	Dust boot		DIX SAS 640	683100015
4	Switch set		DIX SAS 650	683100018

11-00309

subject to change!

11-RoboticAutomaticComponents\J11

Adapter flange

SAS 100 / 200

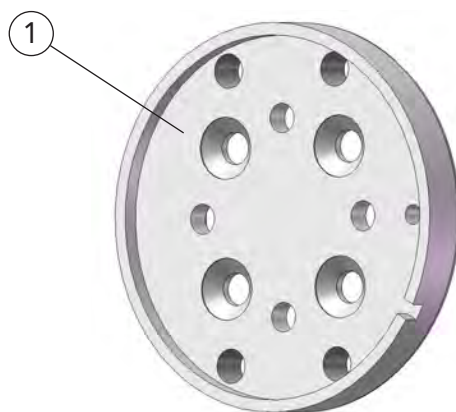

Robot

Pos.	Description	Manu- facturer	Robot typ	Part number	Article number
1	Flange	ABB	IRB 6	DIX ADF 6012	683116012
	Flange	ABB	IRB 1000	DIX ADF 6012	683116012
	Flange	ABB	IRB 1400	DIX ADF 6012	683116012
	Flange	ABB	IRB 1500	DIX ADF 6012	683116012
	Flange	ABB	IRB 1600	DIX ADF 6012	683116012
	Flange	ABB	IRB 2000	DIX ADF 6012	683116012
	Flange	ABB	IRB 2400/2400L	DIX ADF 6012	683116012
	Flange	ABB	IRB 2500	DIX ADF 6012	683116012
	Flange	ABB	IRB 6400	DIX ADF 6017	683116017
	Flange	ABB	IRB 640 M98	DIX ADF 6017	683116017
	Flange	ABB	IRB 2400/10	DIX ADF 6018	683116018
	Flange	ABB	IRB 2400/16	DIX ADF 6018	683116018
	Flange	ABB	IRB 2600	DIX ADF 6018	683116018
	Flange	ABB	IRB 4400 L	DIX ADF 6018	683116018
	Flange	ABB	IRB 4600-20	DIX ADF 6018	683116018

Adapter flange

Pos.	Description	Manu- facturer	Robot typ	Part number	Article number
1	Flange	ABB	IRB 140	DIX ADF 6042	683116042
	Flange	ABB	IRB 4400	DIX ADF 6086	683116086
	Flange	ABB	IRB 4600-40	DIX ADF 6086	683116086
	Flange	ABB	IRB 4600-45	DIX ADF 6086	683116086
	Flange	ABB	IRB 4600-60	DIX ADF 6086	683116086
	Flange	Cloos	Romat 56	DIX ADF 6031	683116031
	Flange	Cloos	Romat 75/76	DIX ADF 6032	683116032
	Flange	Cloos	Romat 310	DIX ADF 6033	683116033
	Flange	Cloos	Romat 320	DIX ADF 6033	683116033
	Flange	Cloos	Romat 350	DIX ADF 6033	683116033
	Flange	Cloos	Romat 410	DIX ADF 6033	683116033
	Flange	Comau	Smart SIX	DIX ADF 6042	683116042
	Flange	Comau	Smart S4	DIX ADF 6221	683116221
	Flange	Comau	Smart NS 12-1.85 ARC	DIX ADF 6221	683116221
	Flange	Comau	Smart NS 16-1.65 ARC	DIX ADF 6221	683116221
	Flange	Comau	Smart NM 16-3.1	DIX ADF 6221	683116221
	Flange	Fanuc	50il	DIX ADF 6002	683116002
	Flange	Fanuc	LR Mate 200 IC	DIX ADF 6002	683116002
	Flange	Fanuc	LR Mate 200 iB	DIX ADF 6002	683116002
	Flange	Fanuc	LR Mate 200 iB/3L	DIX ADF 6002	683116002
	Flange	Fanuc	ARC Mate 100i	DIX ADF 6012	683116012
	Flange	Fanuc	120il	DIX ADF 6012	683116012
	Flange	Fanuc	100	DIX ADF 6012	683116012
	Flange	Fanuc	RJ2S12	DIX ADF 6012	683116012

11-00311

subject to change!

11-RoboticAutomaticComponentsU11

Adapter flange

Pos.	Description	Manufacturer	Robot typ	Part number	Artikle number
1	Flange	Fanuc	M-710iC/20L*	DIX ADF 6012	683116012
	Flange	Fanuc	R 2000iA 165 F/R/L	DIX ADF 6017	683116017
	Flange	Fanuc	R 2000iA 125L	DIX ADF 6017	683116017
	Flange	Fanuc	ARC Mate 100 iC	DIX ADF 6024	683116024
	Flange	Fanuc	ARC Mate 100 iC/6L	DIX ADF 6024	683116024
	Flange	Fanuc	ARC Mate 120 iC	DIX ADF 6024	683116024
	Flange	Fanuc	ARC Mate 120 iC/10L	DIX ADF 6024	683116024
	Flange	Fanuc	100 RJ 3 iC	DIX ADF 6024	683116024
	Flange	Fanuc	ARC Mate 100 iB	DIX ADF 6042	683116042
	Flange	Fanuc	ARC Mate 120 iB	DIX ADF 6042	683116042
	Flange	Fanuc	M-6iB/2 HS	DIX ADF 6042	683116042
	Flange	Fanuc	M 16 iB	DIX ADF 6042	683116042
	Flange	Fanuc	M-710 iC/20L**	DIX ADF 6042	683116042
	Flange	Hitachi	M6100	DIX ADF 6025	683116025
	Flange	Hitachi	MR 6060	DIX ADF 6042	683116042
	Flange	Hyundai	HR006/015	DIX ADF 6028	683116028
	Flange	Hyundai	010L/030L/050	DIX ADF 6028	683116028
	Flange	Kawasaki	JS 6	DIX ADF 6042	683116042
	Flange	Kawasaki	JS 10	DIX ADF 6042	683116042
	Flange	Kawasaki	FA 06 E	DIX ADF 6042	683116042
	Flange	Kawasaki	FA 10 L	DIX ADF 6221	683116221
	Flange	Kuka	KR 16 arc HW	DIX ADF 6026	683116026
	Flange	Kuka	KR 5	DIX ADF 6029	683116029
	Flange	Kuka	KR 5 ARC HW	DIX ADF 6029	683116029
	Flange	Kuka	KR 5 ARC	DIX ADF 6042	683116042
	Flange	Kuka	KR 6 ARC	DIX ADF 6042	683116042

* ø 50 mm
** ø 25 mm

Adapter flange

Pos.	Description	Manu- facturer	Robot typ	Part number	Article number
1	Flange	Kuka	KR 16-L6 ARC	DIX ADF 6042	683116042
	Flange	Kuka	KR 6	DIX ADF 6042	683116042
	Flange	Kuka	KR 6/2	DIX ADF 6084	683116084
	Flange	Kuka	KR 15/2	DIX ADF 6084	683116084
	Flange	Kuka	KR 16	DIX ADF 6084	683116084
	Flange	Kuka	KR 16 L	DIX ADF 6084	683116084
	Flange	Kuka	KR 30L16	DIX ADF 6084	683116084
	Flange	Kuka	KR IR 364/8	DIX ADF 6084	683116084
	Flange	Kuka	KR 125/2	DIX ADF 6085	683116085
	Flange	Kuka	KR 125 L90/2	DIX ADF 6085	683116085
	Flange	Kuka	KR 125 L 100/2	DIX ADF 6085	683116085
	Flange	Kuka	KR 150/2	DIX ADF 6085	683116085
	Flange	Kuka	KR 150 L 110/2	DIX ADF 6085	683116085
	Flange	Kuka	KR 150 L 130/2	DIX ADF 6085	683116085
	Flange	Kuka	KR 30/2	DIX ADF 6086	683116086
	Flange	Manutec	R3	DIX ADF 6070	683116070
	Flange	Manutec	R15	DIX ADF 6070	683116070
	Flange	Manutec	R15 D	DIX ADF 6070	683116070
	Flange	Mitsubishi	RV 12 S	DIX ADF 6042	683116042
	Flange	Mitsubishi	RV 12 SL	DIX ADF 6042	683116042
	Flange	OTC	V 01	DIX ADF 6012	683116012
	Flange	OTC	V 6	DIX ADF 6012	683116012
	Flange	OTC	V 10	DIX ADF 6012	683116012
	Flange	OTC	AX M H3	DIX ADF 6012	683116012
	Flange	OTC	V 6L	DIX ADF 6012	683116012
	Flange	OTC	IRB 471	DIX ADF 6089	683116089

11-00313

subject to change!

11-Robotic-Automatic-Components\J11

Adapter flange

Pos.	Description	Manu- facturer	Robot typ	Part number	Article number
1	Flange	Panasonic	AW 550	DIX ADF 6160	683116160
	Flange	Panasonic	AW 0660	DIX ADF 6160	683116160
	Flange	Panasonic	AW 8010	DIX ADF 6160	683116160
	Flange	Panasonic	VR 006AL 1; 2	DIX ADF 6161	683116161
	Flange	Panasonic	VR 008	DIX ADF 6161	683116161
	Flange	Panasonic	Tawers 1600	DIX ADF 6161	683116161
	Flange	Panasonic	Tawers 1800	DIX ADF 6161	683116161
	Flange	Panasonic	Tawers 1400	DIX ADF 6161	683116161
	Flange	Panasonic	Tawers 1800 TB	DIX ADF 6161	683116161
	Flange	Reis	RV 6	DIX ADF 6103	683116103
	Flange	Reis	RV 6L	DIX ADF 6103	683116103
	Flange	Reis	RV 20-6	DIX ADF 6103	683116103
	Flange	Reis	RV20-6HW	DIX ADF 6106	683116106
	Flange	Reis	RV20-10HW	DIX ADF 6106	683116106
	Flange	Reis	RV30-10HW	DIX ADF 6106	683116106
	Flange	Reis	RV 12	DIX ADF 6221	683116221
	Flange	Reis	RV 12L	DIX ADF 6221	683116221
	Flange	Reis	RV 15	DIX ADF 6221	683116221
	Flange	Reis	RV 16	DIX ADF 6221	683116221
	Flange	Reis	RV 20-16	DIX ADF 6221	683116221
	Flange	Reis	RV 30-16	DIX ADF 6221	683116221
	Flange	SEF	SR25/A2	DIX ADF 6221	683116221
	Flange	Stäubli	TX 60	DIX ADF 6002	683116002
	Flange	Stäubli	TX 60L	DIX ADF 6002	683116002
	Flange	Stäubli	TX 90	DIX ADF 6103	683116103

11-00314

subject to change!

11-Robotic-AutomaticComponents\J11

Adapter flange

Pos.	Description	Manu- facturer	Robot typ	Part number	Article number
1	Flange	Stäubli	TX 90L	DIX ADF 6103	683116103
	Flange	Stäubli	TX 90XL	DIX ADF 6103	683116103
	Flange	Yaskawa	Motoman HP 3 C	DIX ADF 6002	683116002
	Flange	Yaskawa	Motoman HP 3 J	DIX ADF 6002	683116002
	Flange	Yaskawa	Motoman L 106	DIX ADF 6040	683116040
	Flange	Yaskawa	Motoman K 6S	DIX ADF 6042	683116042
	Flange	Yaskawa	Motoman K 10S	DIX ADF 6042	683116042
	Flange	Yaskawa	Motoman K 205S	DIX ADF 6042	683116042
	Flange	Yaskawa	Motoman SRC 6	DIX ADF 6042	683116042
	Flange	Yaskawa	Motoman JS 6	DIX ADF 6042	683116042
	Flange	Yaskawa	Motoman 3S 10	DIX ADF 6042	683116042
	Flange	Yaskawa	Motoman SK 6	DIX ADF 6042	683116042
	Flange	Yaskawa	Motoman SK 10	DIX ADF 6042	683116042
	Flange	Yaskawa	Motoman SK 16	DIX ADF 6042	683116042
	Flange	Yaskawa	Motoman HP20/UP 20	DIX ADF 6042	683116042
	Flange	Yaskawa	Motoman HP 6 UP 6	DIX ADF 6042	683116042
	Flange	Yaskawa	Motoman YRUP 20-A00	DIX ADF 6042	683116042
	Flange	Yaskawa	Motoman YRUP 50N-A00	DIX ADF 6042	683116042
	Flange	Yaskawa	Motoman MH6	DIX ADF 6042	683116042
	Flange	Yaskawa	Motoman Bohrbild 35° verdreht	DIX ADF 6042/1	6831160421
	Flange	Yaskawa	Motoman EA 1400N	DIX ADF 6047	683116047
	Flange	Yaskawa	Motoman EA 1900N	DIX ADF 6047	683116047
	Flange	Yaskawa	Motoman MA 1400	DIX ADF 6047	683116047
	Flange	Yaskawa	Motoman MA 1900	DIX ADF 6047	683116047
	Flange	Yaskawa	Motoman MA 3100	DIX ADF 6047	683116047
	Flange	Yaskawa	Motoman DX 100	DIX ADF 6047	683116047

11-00315

subject to change!

11-RoboticAutomaticComponents\J11

Adapter flange ADFR

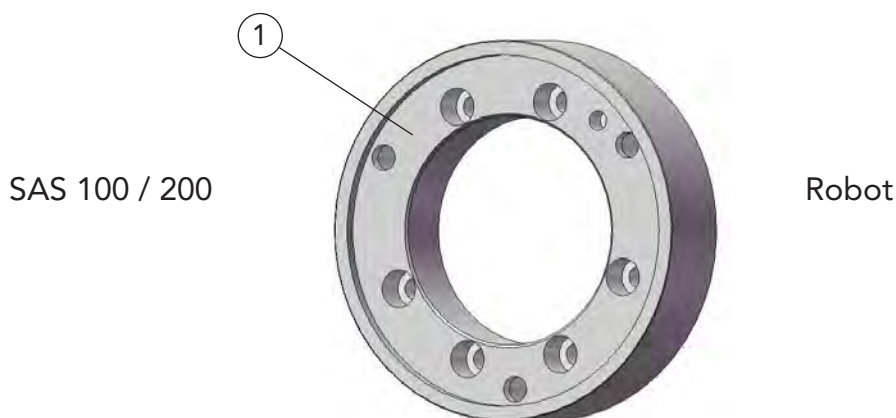

Pos.	Description	Manu- facturer	Robot typ	Part number	Article number
1	Flange	ABB	IRB 1600 ID	DIX ADFR 6302	687003302
	Flange	Fanuc	ARC Mate 100iC	DIX ADFR 6303	687003303
	Flange	Fanuc	ARC Mate 100iC/6L	DIX ADFR 6303	687003303
	Flange	Fanuc	ARC Mate 120iC	DIX ADFR 6303	687003303
	Flange	Fanuc	ARC Mate 120iC/10L	DIX ADFR 6303	687003303
	Flange	Kuka	KR5 arc HW	DIX ADFR 6304	687003304
	Flange	Yaskawa	Motoman EA 1400 N	DIX ADFR 6300	687003300
	Flange	Yaskawa	Motoman EA 1800 N	DIX ADFR 6300	687003300
	Flansch	Yaskawa	Motoman EA 1900 N	DIX ADFR 6300	687003300
	Flange	Yaskawa	Motoman MA 1400	DIX ADFR 6300	687003300
	Flange	Yaskawa	Motoman VA 1400	DIX ADFR 6300	687003300
	Flange	Yaskawa	Motoman SSA 2000	DIX ADFR 6300	687003300

11-00316

subject to change!

11-Robotic-Automatic-Components\J11

Adapter flange ADFR

Pos.	Description	Manu- facturer	Robot typ	Part number	Article number
1	Flange	OTC Daihen	AX-V4 AP	DIX ADFR 6301	687003301
	Flange	OTC Daihen	AX-V4 LAP	DIX ADFR 6301	687003301
	Flange	OTC Daihen	All-B4	DIX ADFR 6306	687003306
	Flange	OTC Daihen	All-B4L	DIX ADFR 6306	687003306
	Flange	Panasonic	TB 1800	DIX ADFR 6309	687003309
	Flange	Reis	RV20-6HW	DIX ADFR 6308	687003308
	Flange	Reis	RV20-10HW	DIX ADFR 6308	687003308
	Flange	Reis	RV30-10HW	DIX ADFR 6308	687003308

11-00317

subject to change!

11-Robotic-Automatic-Components\J11

Torch bracket, fixed

DIX PHF 100

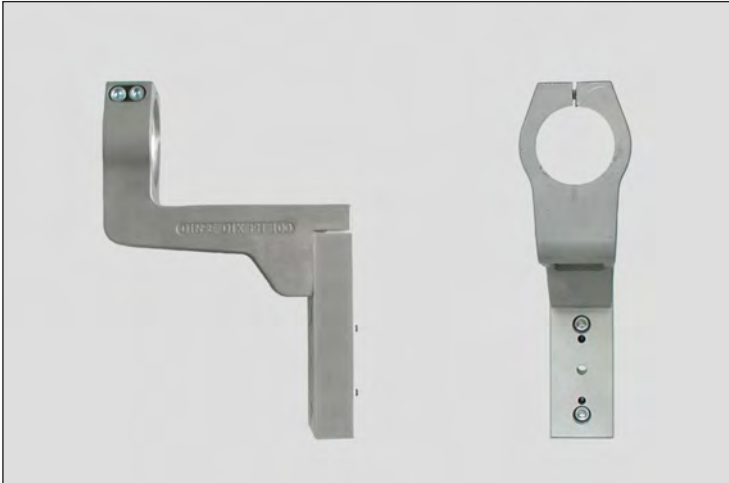

Torch bracket, fixed (side view and front view)



Torch bracket, fixed (complete torch system, separable, with shock sensor DIX SAS 100, application sample)



Torch bracket, fixed (complete torch system, double separable, with shock sensor DIX SAS 100, application sample)

Technical data:

Torch bracket, fixed

TCP for torch heads, 45° without offset, with shock sensor

DIX SAS 100:

400 mm to robotic flange

Technical benefits:

- All common TCP's (different lengths and angles) with adapter flanges and further retainers attainable
- Torch brackets made of aluminium cast alloy
- High mechanical strength
- High precision
- Low weight
- Very good corrosion resistance

Application:

- For DINSE torch systems
gas cooled
DIX MET / METT 310
liquid cooled
DIX METZ / METTZ 600

Torch bracket, fixed

DIX PHF 110



Torch bracket, fixed (side view and front view)



Torch bracket, fixed (complete torch system, separable, with shock sensor DIX SAS 100, application sample)



Torch bracket, fixed (complete torch system, double separable, with shock sensor DIX SAS 100, application sample)

Technical data:

Torch bracket, fixed

Angle, horizontal: 30°

TCP for torch heads,
with shock sensor

DIX SAS 100:

437 mm to robotic flange

(electrode stand out: 5 mm)

Technical benefits:

- ▶ All common TCP's (different lengths and angles) with adapter flanges and further retainers attainable
- ▶ Torch brackets made of aluminium cast alloy
- ▶ High mechanical strength
- ▶ High precision
- ▶ Low weight
- ▶ Very good corrosion resistance

Application:

- ▶ For DINSE torch systems
liquid cooled
DIX METZ / METTZ 600

Torch bracket, adjustable

DIX PHW 100

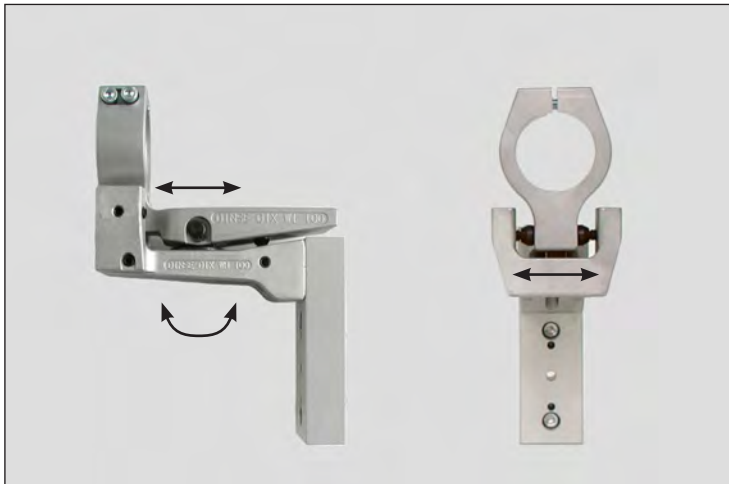

Torch bracket, adjustable (side view and front view)



Torch bracket, adjustable (complete torch system, separable, with shock sensor DIX SAS 100, application sample)



Torch bracket, adjustable (complete torch system, double separable, with shock sensor DIX SAS 100, application sample)

Technical data:

Torch bracket, adjustable

TCP for torch heads, 45° without offset, with shock sensor

DIX SAS 100:

400 mm to robotic flange

Technical benefits:

- ▶ Flexible TCP adjustment
- ▶ All common TCP's (different lengths and angles) with adapter flanges and further retainers attainable
- ▶ Torch brackets made of aluminium cast alloy
- ▶ High mechanical strength
- ▶ High precision
- ▶ Low weight
- ▶ Very good corrosion resistance

Application:

- ▶ For DINSE torch systems
gas cooled
DIX MET / METT 310
liquid cooled
DIX METZ / METTZ 600

Tool storage system

DIX WAS 100



Storage station with fixture mandrel, tool holder and SAS - flange

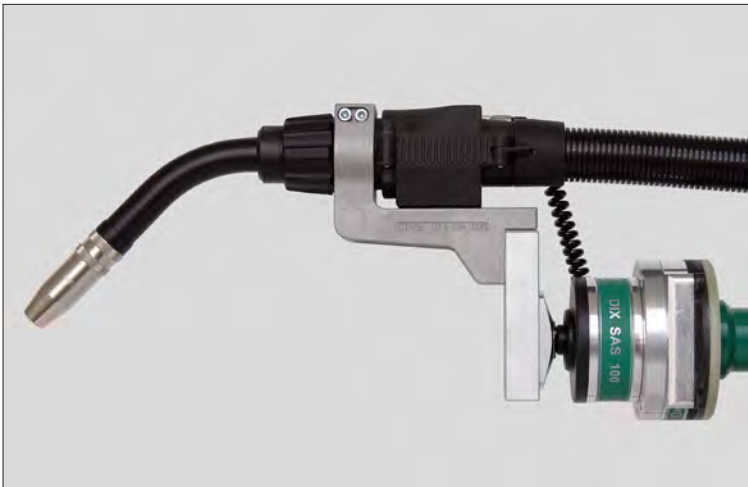

Torch system with fixture mandrel, tool holder and SAS - flange mounted on robot



Torch system in the storage station uncoupled from robot

Technical data:

Fixture mandrel DIX WAS KD 3100

Tool holder DIX WAS WT 3200

Storage station DIX WAS WS 3300

SAS - flange DIX WAS FL 100

Adapter flange DIX 61 - 3 - 2xxx
(bore pattern dependent of robot type)

Dimension (D/H): \varnothing 100 / 4.5 mm

Technical benefits:

- High flexibility and guaranteed system availability through quick tool change with storage station
- Tool position can be reproduced on the robot through positive interlocking
- Pneumatic clamping system independent of robot
- Monitoring the tool storage through reed contact
- Auto-clamping through springs during power failure
- **Option:** Tool identification in the storage station

Application:

- For all common tools
- Replacement of wearing parts without stopping production
- For change production processes

Tool storage system

DIX WAS 100

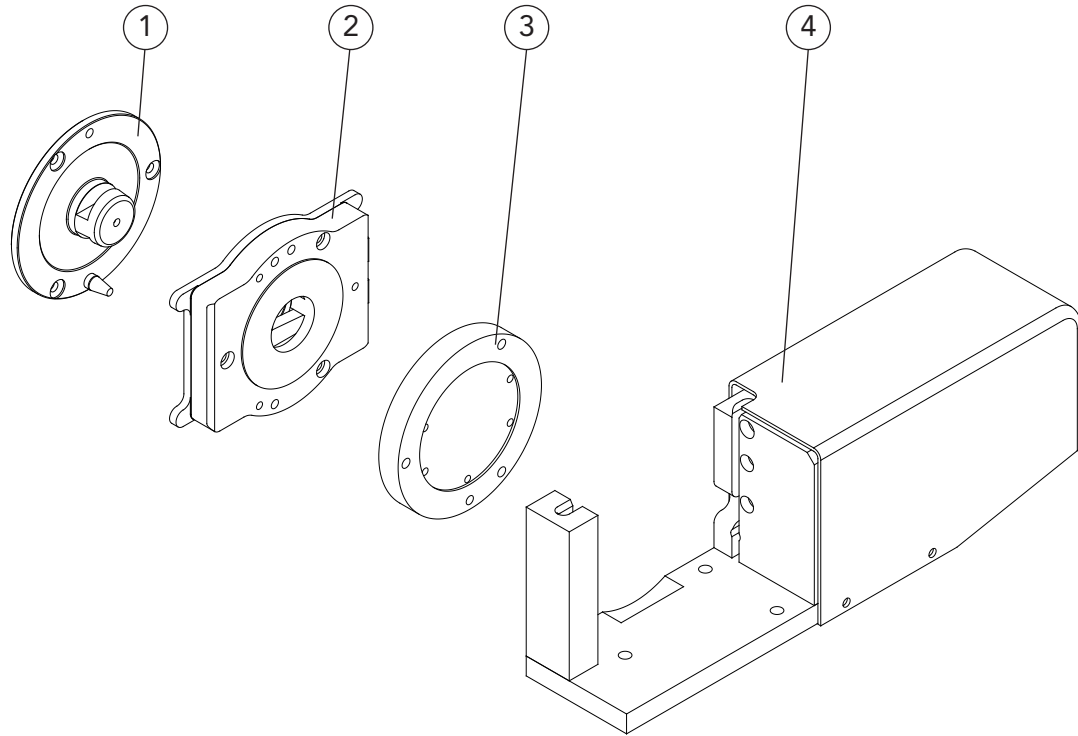

11-00322

11-RoboticAutomaticComponents\J11 subject to change!

Pos.	Description	Part number	Article number
1	Fixture mandrel	DIX WAS KD 3100	683403100
2	Tool holder	DIX WAS WT 3200	683403200
3	SAS - flange	DIX WAS FL 100	683403310
4	Storage station	DIX WAS WS 3300	683403300

- Variants deviating of the standard fittings on request.
The corresponding adapter flange you find in the accessories list!

Tool storage system

DIX WAS 100



1



2

Pos.	Description	Part number	Article number
1	Switch (f. storage station)	DIX WAS WS 3307	683403307
2	Manual tool changer	DIX WAS HW 3400	683403400

11-00323

subject to change!

11-RoboticAutomaticComponents\J11



Tool storage system
Storage station

DIX WAS 100

DIX WAS WS 3300

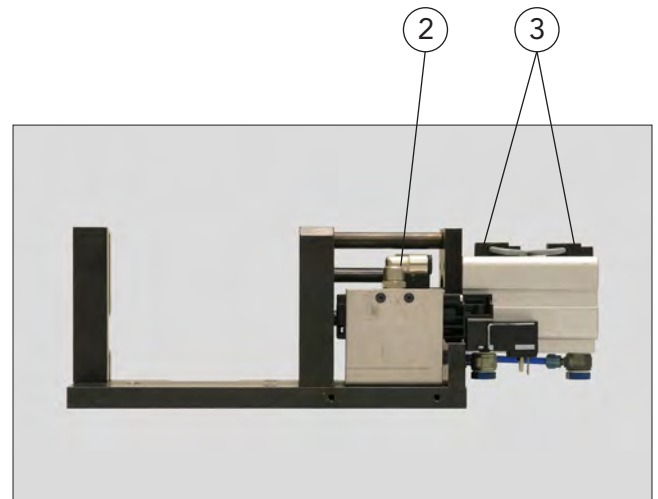
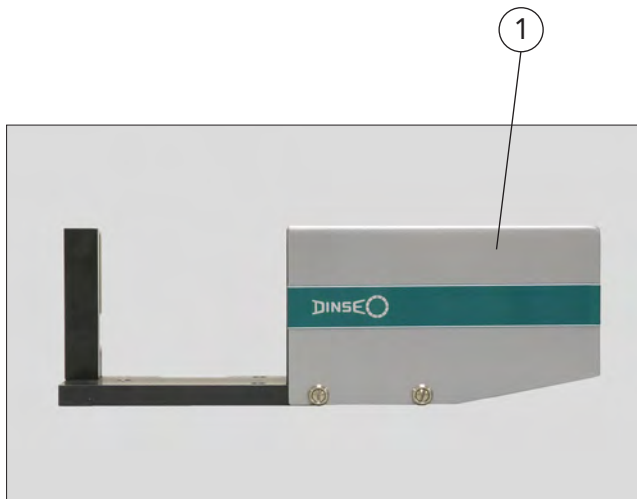

Pos.	Description	Part number	Article number
1	Cap	DIX WAS WS 3306	683403306
2	Valve	DIX WAS WS 3305	683403305
3	Reed contact (2 pcs. available)	DIX WAS WS 3304	683403304

11-00324

subject to change!

11-RoboticAutomaticComponents\J11



Checking and aligning system for standard torch heads



Checking jig DIX PV 100

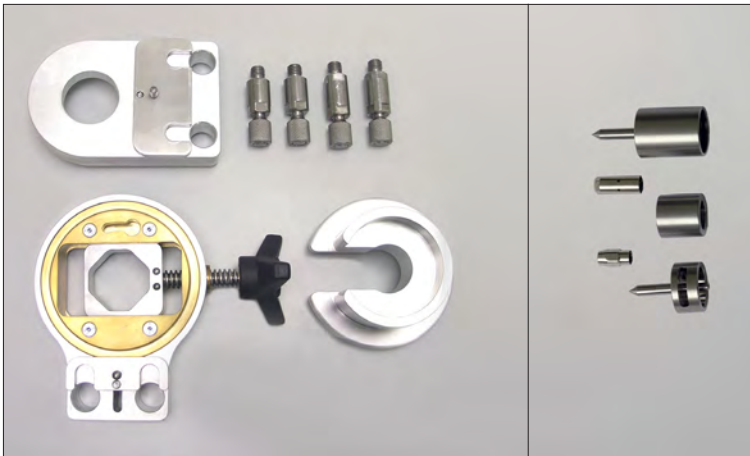

Aligning module DIX JM 100 (left) and aligning set DIX JS 350/520 (right)

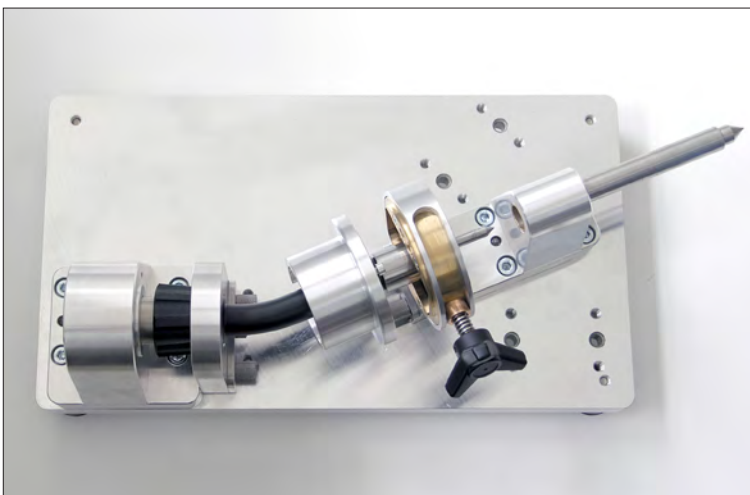

Checking jig with torch head and aligning module (application sample)

Technical data:

Checking jig DIX PV 100

Aligning module DIX JM 100

Aligning sets DIX JS 350/520
(for standard torch heads) DIX JS 540
DIX JS 560

Technical benefits:

- Precise checking jig for position control of the TCP, made of a high grade aluminium alloy for a long lifetime
- Aligning and checking of the standard torch heads concerning parallelism and center of contact tip
- Bore pattern in the checking jig with standard positions for torch heads, (0°, 22°, 45°)
- Aligning module to re-aligning the inner and outer parts of the torch head separately.

Application:

- For DINSE standard torch heads
gas cooled
DIX MET 350/352/354
liquid cooled
DIX METZ 520/522/544
DIX METZ 540/542/544
DIX METZ 560/562/564
DIX METZ 570/572/574
- Quality assurance in welding production

Checking and aligning system for standard torch heads

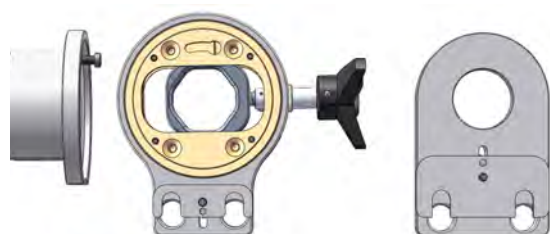
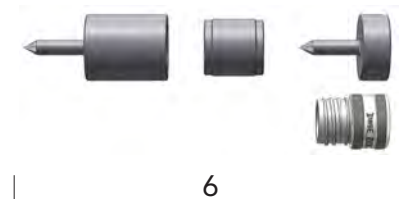
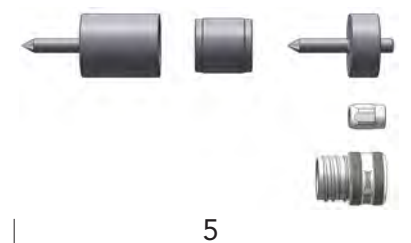
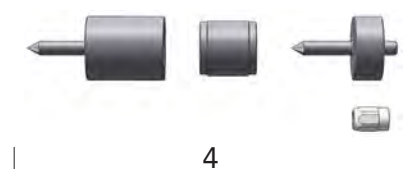
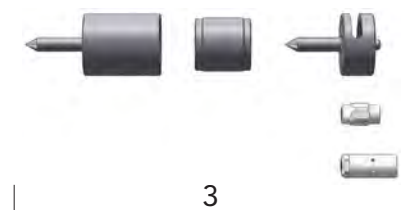
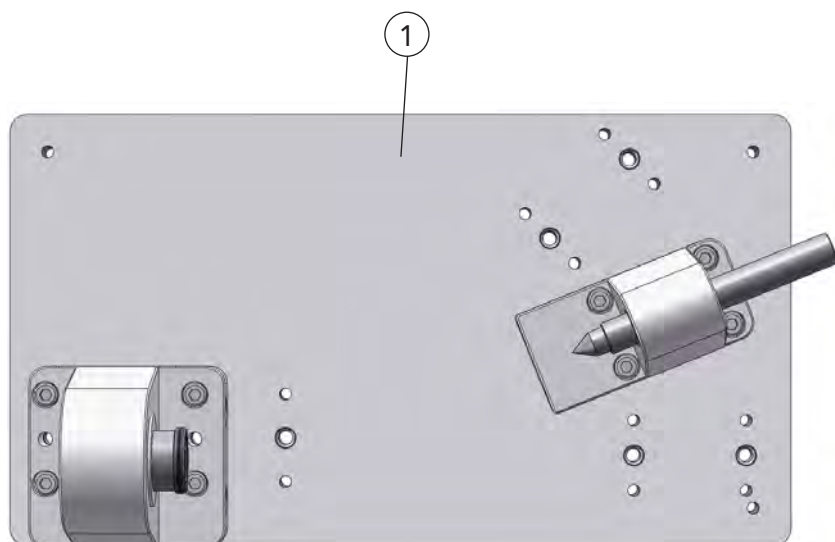

2

Pos.	Description	Part number	Article number
1	Checking jig, compl. (with torch adapter DIX PVP 100, support set DIX PVS 100 and set up pins DIX PVL 106, DIX PVL 108)	DIX PV 100	685300101
2	Aligning module, compl.	DIX JM 100	685305100
3	Aligning set, 350/520	DIX JS 350/520	685305200
4	Aligning set, 540	DIX JS 540	685305210
5	Aligning set, 560	DIX JS 560	685305220
5	Aligning set, 570	DIX JS 570	685305250

► Variants deviating of the standard fittings on request.

11-00326

subject to change!

11-Robotic-AutomaticComponentsU11



Checking jig

DIX PV 100

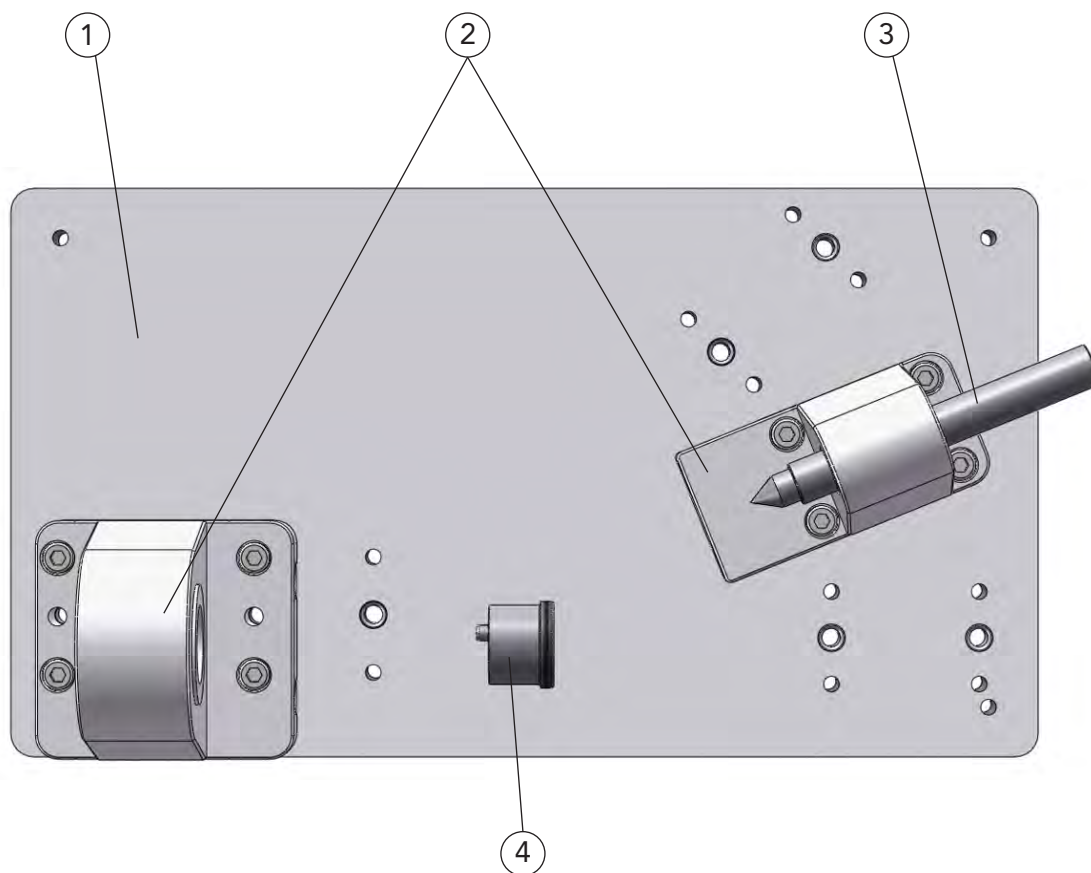

Pos. Description

Part number

Article number

1 Base plate

DIX PVB 100

685301101

2 Support set
(fixing and gauge support)

DIX PVS 100

685302105

3 Set up pin
(for contact tips with outside diameter: 6 mm)
Set up pin
(for contact tips with outside diameter: 8 mm)

DIX PVL 106

685302115

DIX PVL 108

685302114

4 Torch adapter

DIX PVP 100

685303112

11-00327

subject to change!

11-Robotic-AutomaticComponents\J11



Aligning sets

DIX JS	350/520
DIX JS	540
DIX JS	560
DIX JS	570

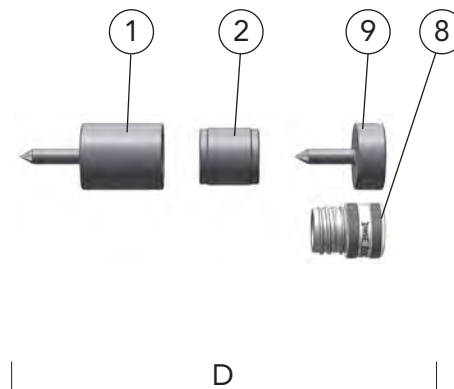
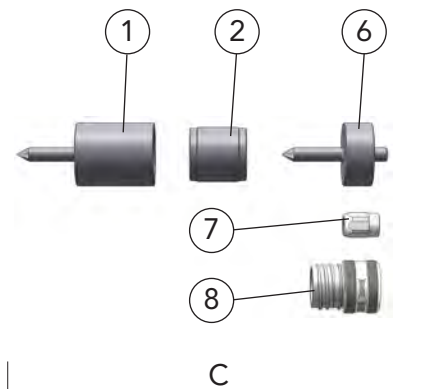
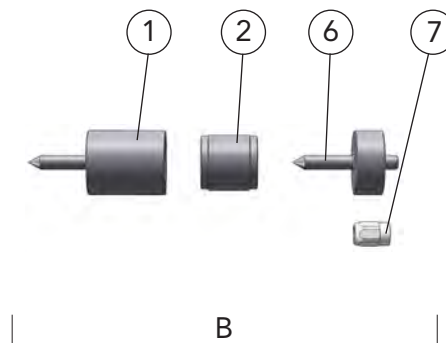
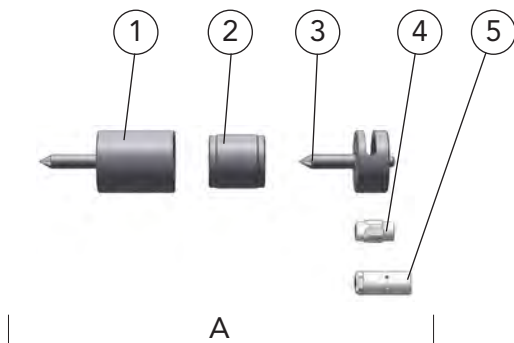

Pos.	Description	Part number	Article number
A	Aligning set	DIX JS 350/520	685305200
B	Aligning set	DIX JS 540	685305210
C	Aligning set	DIX JS 560	685305220
D	Aligning set	DIX JS 570	685305250
1	Aligning cylinder	DIX JSZ 104	685305201
2	Aligning adapter	DIX JSA 100	685305211
3	Aligning gauge	DIX JSL 106	685305221
4	Clamp nut	DIX 4-1-MAS	6390452000
5	Clamp nut	DIX CS 300	6390433000
6	Aligning gauge	DIX JSL 108	685305222
7	Clamp nut	DIX 4-2-MAS	6390454000
8	Screw adapter	DIX SAD 2-404/540	628140000
9	Aligning gauge	DIX JSL 109 M8	685305224

11-00328

subject to change!

11-RoboticAutomaticComponentsU11



Checking and aligning system for standard torch heads



Checking jig DIX PV 150

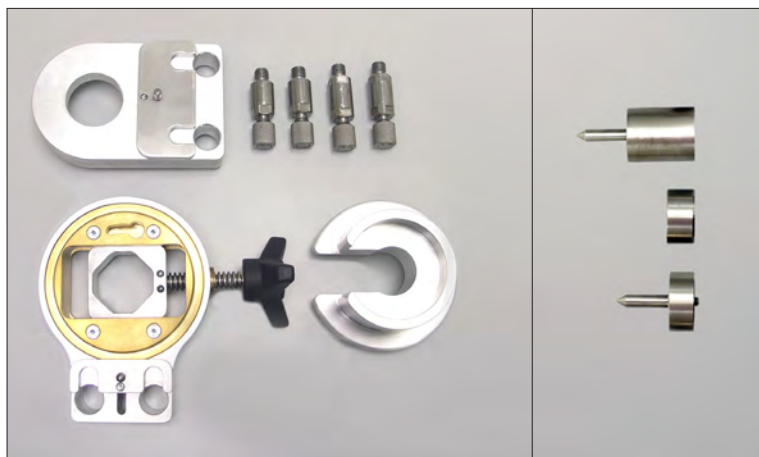

Aligning module DIX JM 100 (left) and aligning set DIX JS 390/590 (right)



Checking jig with torch head and aligning module (application sample)

Technical data:

Checking jig DIX PV 150

Aligning module DIX JM 100

Aligning set DIX JS 390/590
(for standard torch heads)

Technical benefits:

- Precise checking jig for position control of the TCP, made of a high grade aluminium alloy for a long lifetime
- Aligning and checking of the standard torch heads concerning parallelism and center of contact tip
- Bore pattern in the checking jig with standard positions for torch heads, (0°, 22°, 45°)
- Aligning module to re-aligning the inner and outer parts of the torch head separately.

Application:

- For DINSE standard torch heads
gas cooled
DIX MET 390/392/394
liquid cooled
DIX METZ 590/592/594
- Quality assurance in welding production

Checking and aligning system for standard torch heads

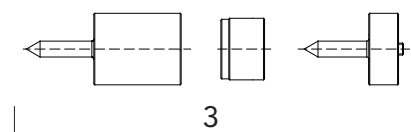
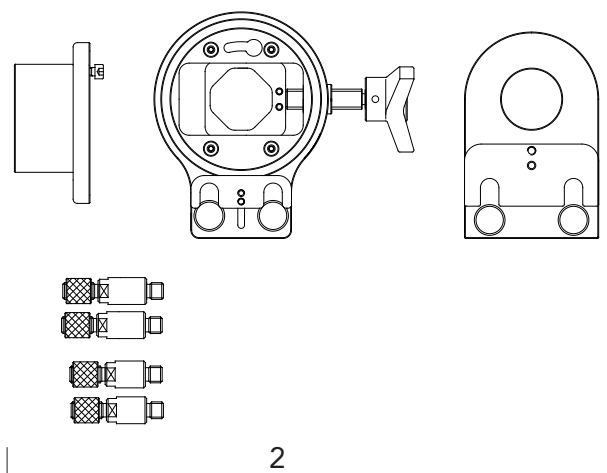
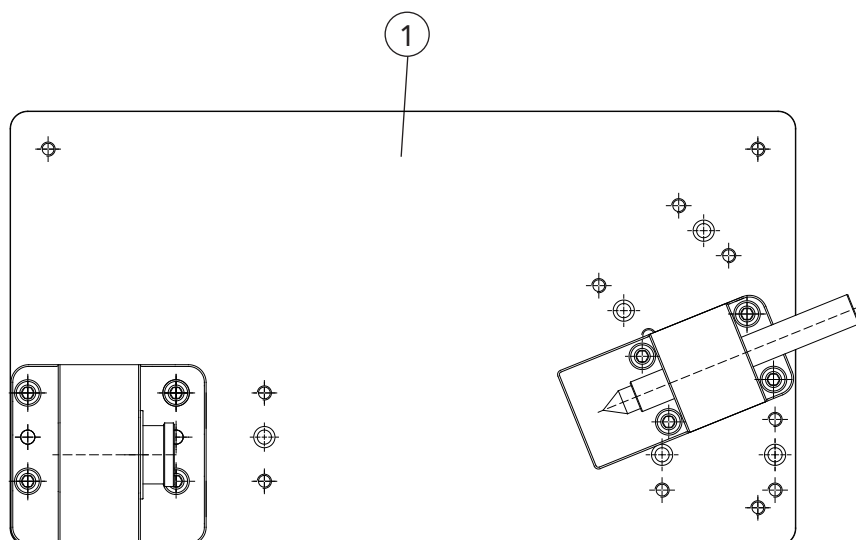

Pos.	Description	Part number	Article number
1	Checking jig, compl. (with torch adapter DIX PVP 100, support set DIX PVS 100 and set up pin DIX PVL 106, DIX PVL 108)	DIX PV 150	685300151
2	Aligning module, compl.	DIX JM 100	685305100
3	Aligning set, 390/590	DIX JS 390/590	685305230

► Variants deviating of the standard fittings on request.



Checking jig

DIX PV 150

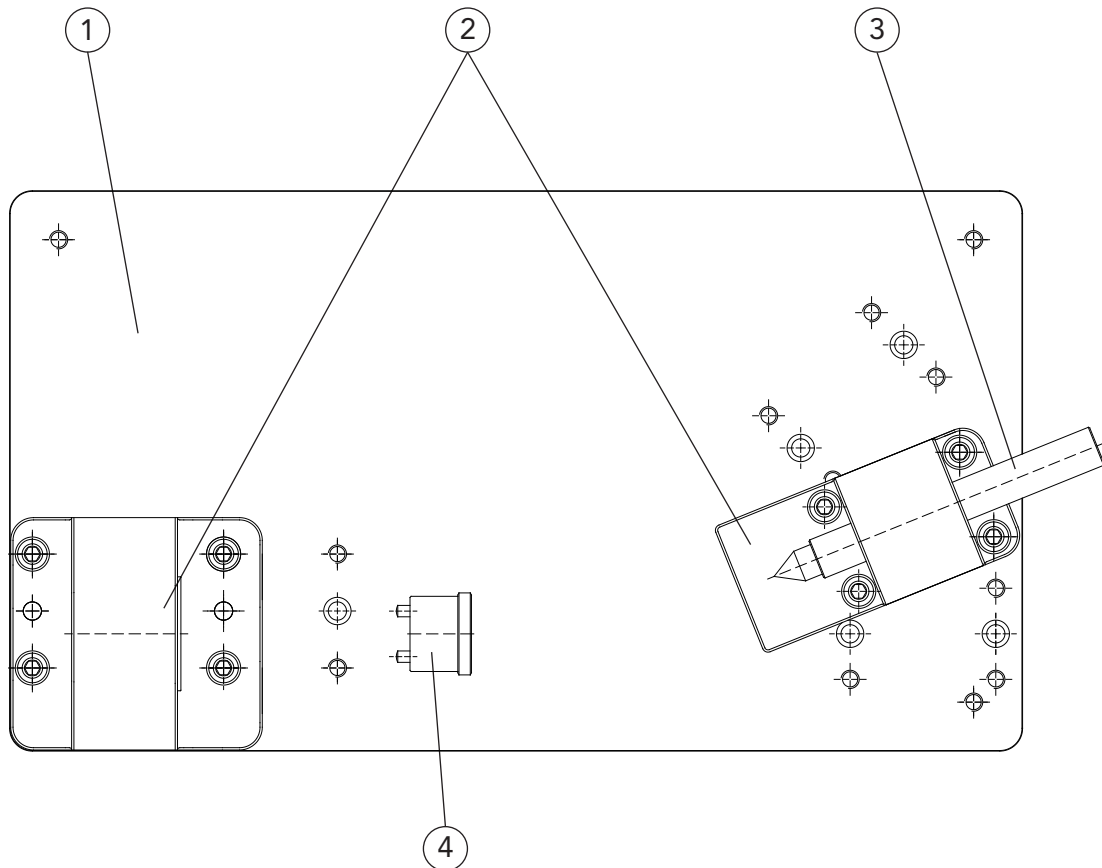

Pos.	Description	Part number	Article number
1	Base plate	DIX PVB 150	685301151
2	Support set (fixing and gauge support)	DIX PVS 100	685302105
3	Set up pin (for contact tips with outside diameter: 6 mm)	DIX PVL 106	685302115
	Set up pin (for contact tips with outside diameter: 8 mm)	DIX PVL 108	685302114
4	Torch adapter	DIX PVP 100	685303112

11-00331

subject to change!

11-Robotic-Automatic-Components\J11



Aligning set

DIX JS 390/590

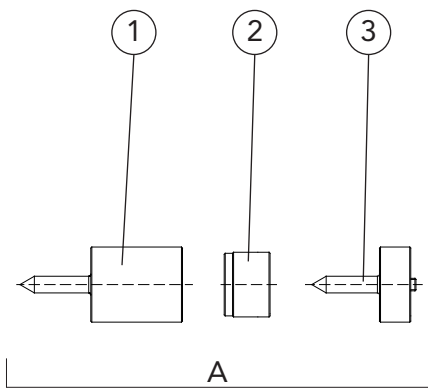

Pos.	Description	Part number	Article number
A	Aligning set	DIX JS 390/590	685305230
1	Aligning cylinder	DIX JSZ 104	685305201
2	Aligning adapter	DIX JSA 101	685305212
3	Aligning gauge	DIX JSL 107	685305223

11-00332

subject to change!

11-RoboticAutomaticComponents\J11

Aligning module

DIX JM 100

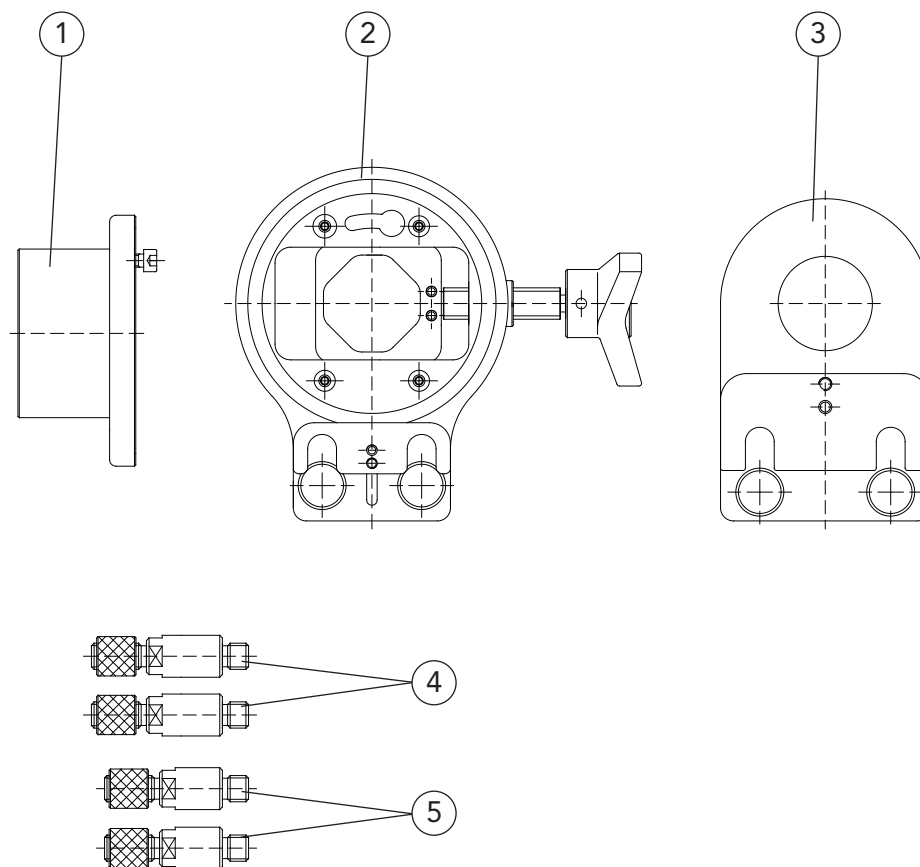

Pos.	Description	Part number	Article number
1	Aligning socket	DIX JB 100	685305130
2	Aligning tool	DIX JW 100	685305110
3	Aligning bracket	DIX JH 100	685305120
4	Aligning pin - W	DIX JBW 100	685305140
5	Aligning pin - H	DIX JBH 100	685305150

11-00333

subject to change!

11-RoboticAutomaticComponents\J11



Checking jig for torch systems

DIX PV 200

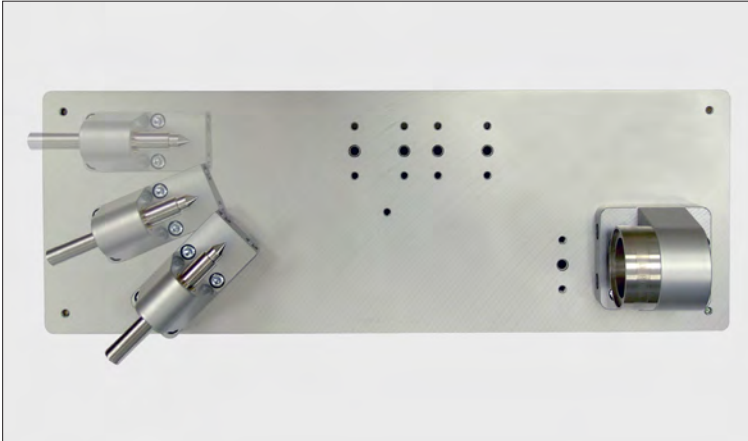

Checking jig DIX PV 200

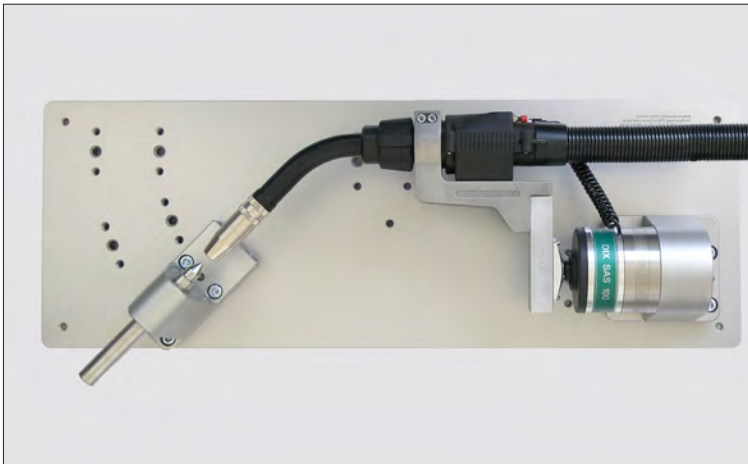

Checking jig with complete torch system, separable, torch bracket, fixed and shock sensor DIX SAS 100 (application sample)



Checking jig with complete torch system, double separable, torch bracket, PUSH-PUSH/PUSH-PULL and shock sensor DIX SAS 200 (application sample)

Technical data:

Checking jig

TCP for torch heads, 45° without offset,
with shock sensor
DIX SAS 100/200:
400 mm to robotic flange

Technical benefits:

- Precise checking jig for position control of the TCP, made of a high grade aluminium alloy for a long lifetime
- Checking of the standard torch heads concerning parallelism and center of contact tip with complete system of torch set, torch bracket and shock sensor
- Bore pattern in the checking jig with standard positions for torch heads, (0°, 22°, 45°)

Application:

- For DINSE standard torch heads
gas cooled
DIX MET 350/352/354
liquid cooled
DIX METZ 520/522/524
DIX METZ 540/542/544
DIX METZ 560/562/564
DIX METZ 570/572/574
- Quality assurance in welding production

Checking jig

DIX PV 200

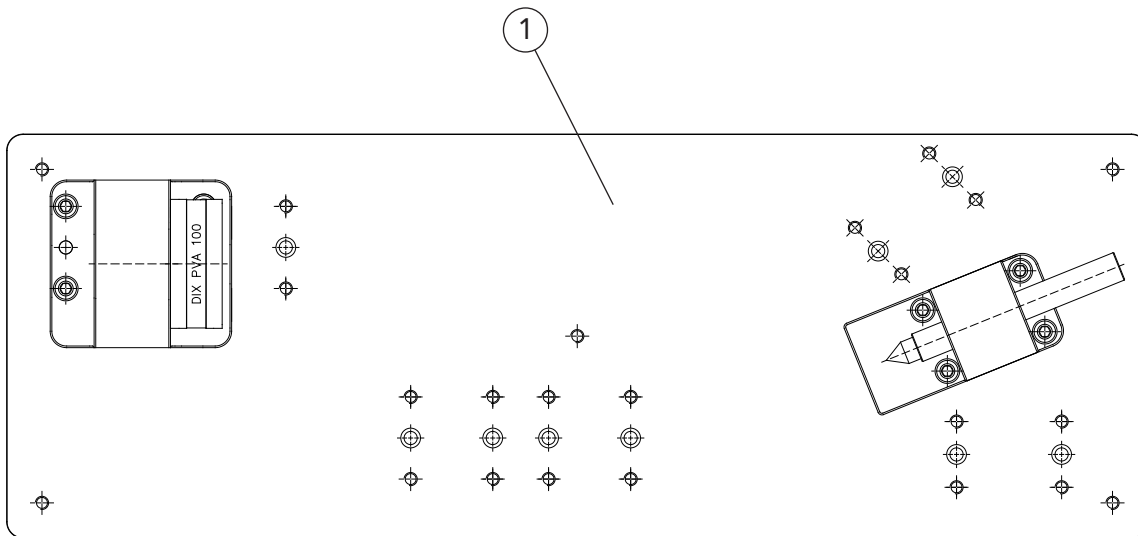

11-00335

subject to change!

11-Robotic-Automatic-Components\J11

Pos.	Description	Part number	Article number
1	Checking jig, compl. (with SAS adapter DIX PVA 100, support set DIX PVS 100 and set up pins DIX PVL 106, DIX PVL 108)	DIX PV 200	685300201



► Variants deviating of the standard fittings on request.

Checking jig

DIX PV 200

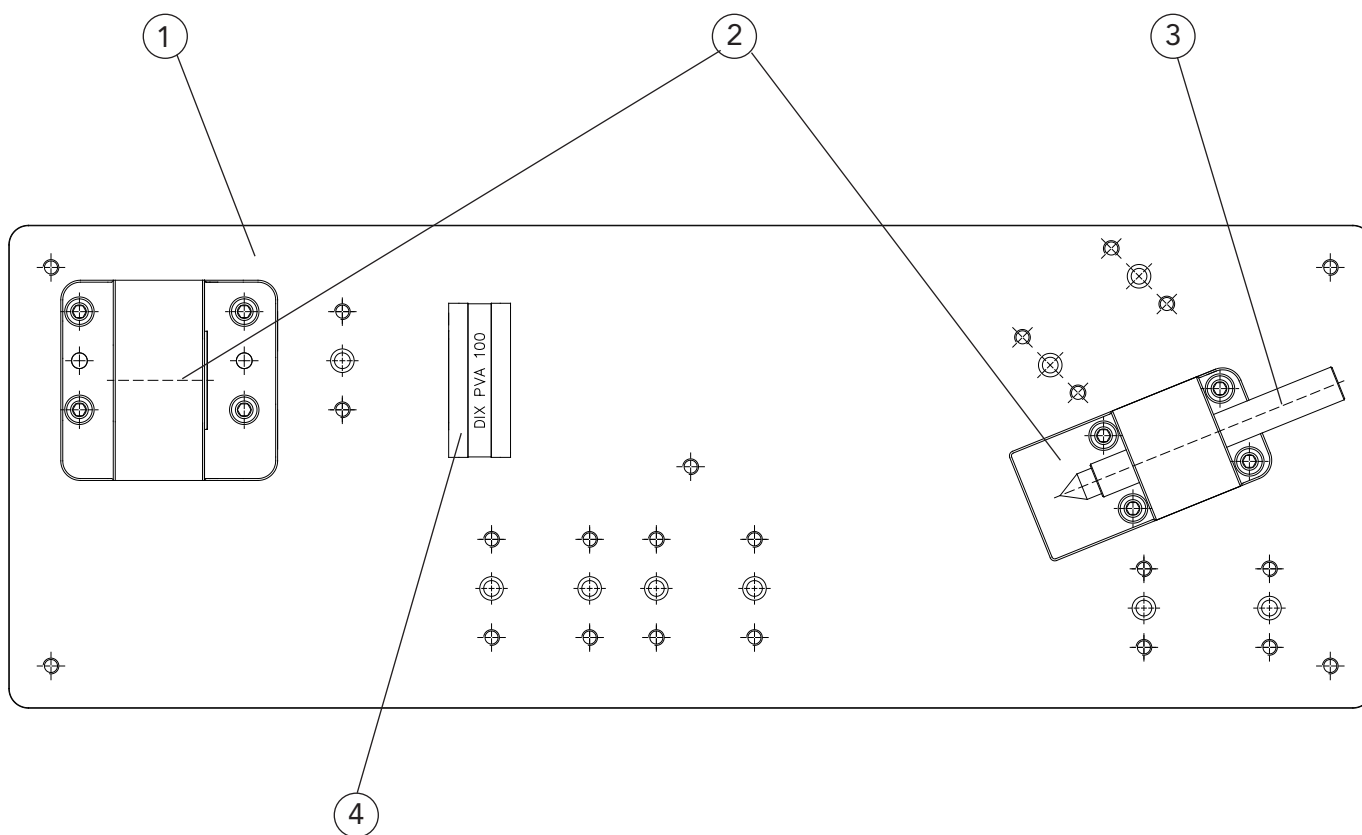

Pos.	Description	Part number	Article number
1	Base plate	DIX PVB 200	685301201
2	Support set (fixing and gauge support)	DIX PVS 100	685302105
3	Set up pin (for contact tips with outside diameter: 6 mm)	DIX PVL 106	685302115
	Set up pin (for contact tips with outside diameter: 8 mm)	DIX PVL 108	685302114
4	SAS adapter	DIX PVA 100	685303160

11-00336

subject to change!

11-Robotic-AutomaticComponents\J11



Checking jig for torch systems

DIX PV 250

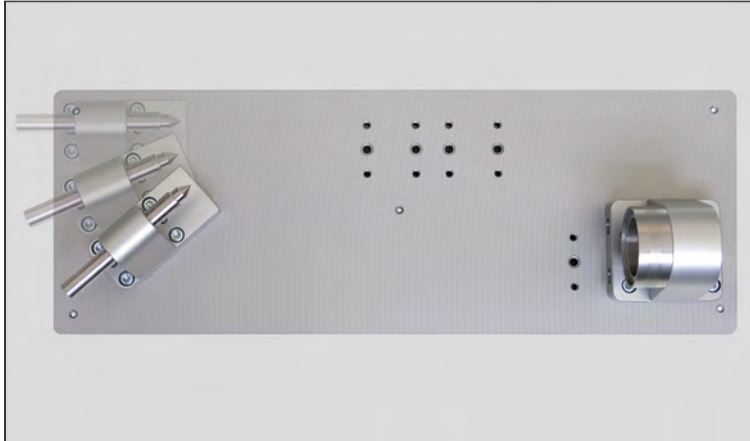

Checking jig DIX PV 250



Checking jig with complete torch system, separable, torch bracket, fixed and shock sensor DIX SAS 100 (application sample)

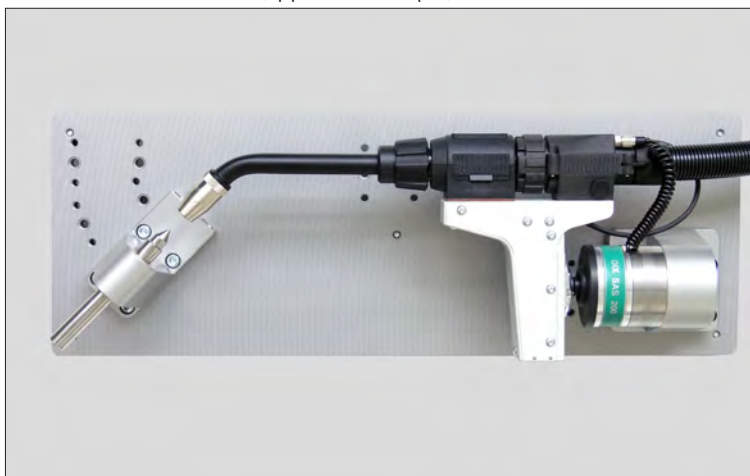

Checking jig with complete torch system, double separable, torch bracket, PUSH-PUSH/PUSH-PULL and shock sensor DIX SAS 200 (application sample)

Technical data:

Checking jig

TCP for torch heads, 45° with offset,
vertical: 54 mm,
with shock sensor
DIX SAS 100/200:
441 mm to robotic flange

Technical benefits:

- Precise checking jig for position control of the TCP, made of a high grade aluminium alloy for a long lifetime
- Checking of the standard torch heads concerning parallelism and center of contact tip with complete system of torch set, torch bracket and shock sensor
- Bore pattern in the checking jig with standard positions for torch heads, (0°, 22°, 45°)

Application:

- For DINSE standard torch heads
gas cooled
DIX MET 390/392/394
liquid cooled
DIX METZ 590/592/594
- Quality assurance in welding production

Checking jig

DIX PV 250

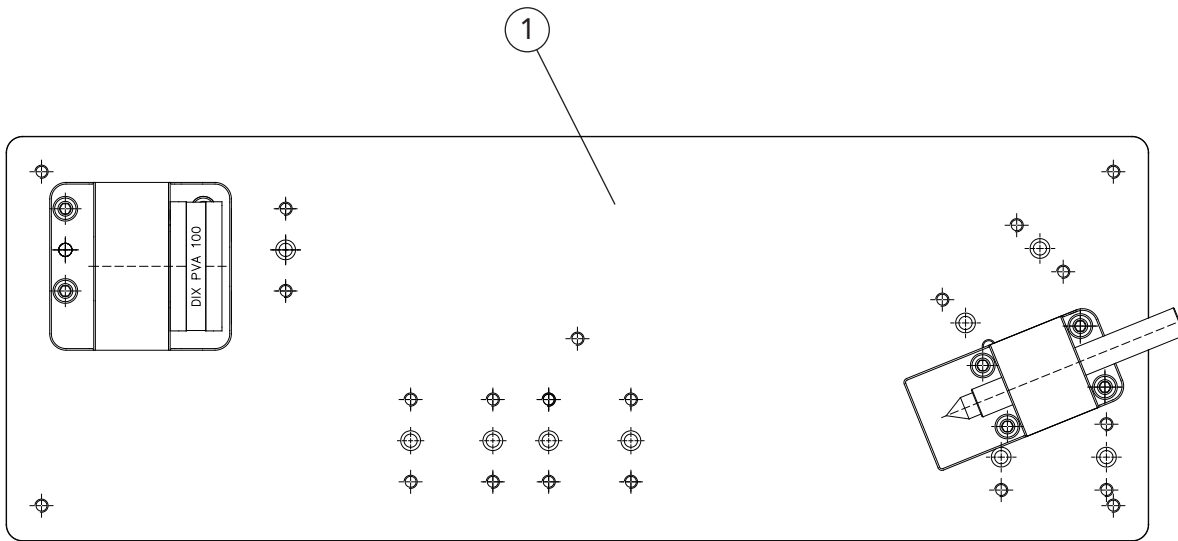

11-00338

subject to change!

11-Robotic-AutomaticComponents\J11

Pos.	Description	Part number	Article number
1	Checking jig, compl. (with SAS adapter DIX PVA 100, support set DIX PVS 100 and set up pins DIX PVL 106, DIX PVL 108)	DIX PV 250	685300251



► Variants deviating of the standard fittings on request.

Checking jig

DIX PV 250

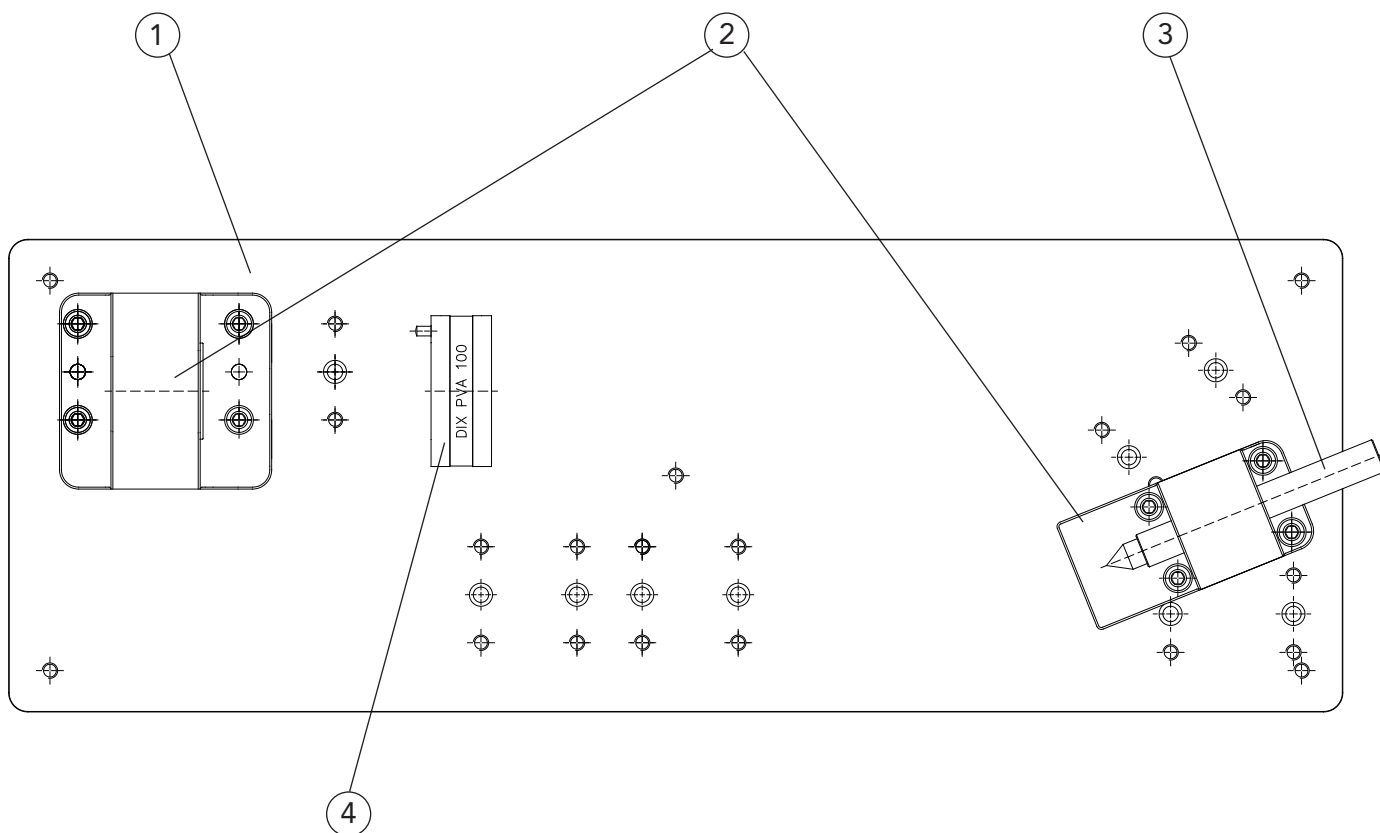

Pos.	Description	Part number	Article number
1	Base plate	DIX PVB 250	685301251
2	Support set (fixing and gauge support)	DIX PVS 100	685302105
3	Set up pin (for contact tips with outside diameter: 6 mm)	DIX PVL 106	685302115
	Set up pin (for contact tips with outside diameter: 8 mm)	DIX PVL 108	685302114
4	SAS adapter	DIX PVA 100	685303160

11-00339

subject to change!

11-Robotic-Automatic-Components\J11



Torch cleaning station

DIX PRS 600



Torch cleaning station DIX PRS 600



Optional with wire cutter DIX PRA 600 and assembly fixture DIX PRF 600

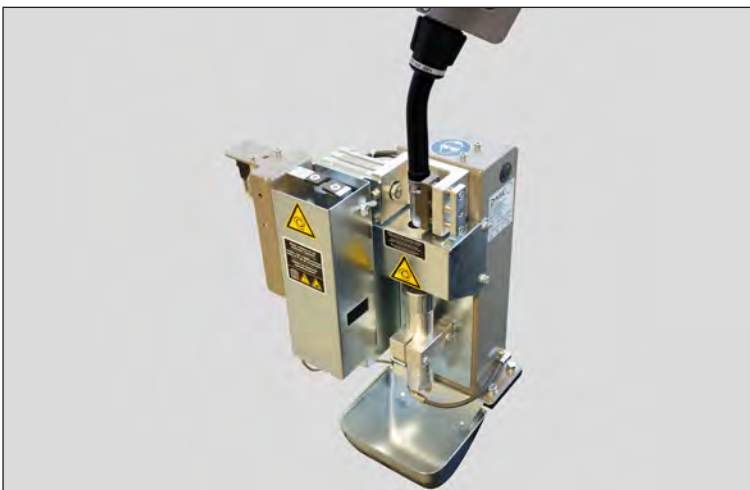

Robot with mounted DINSE torch head during the cleaning in the torch cleaning station

Technical data:

Working pressure	6 bar
Air consumption	7 l/s
Cleaning time, max	4 s
Operating voltage	24 V _{DC}
Protection class	IP 23
Dimension(L/B/H)	180/260/350 mm
Weight	9,5 kg
Power consumption	2,5 VA

Technical benefits:

- Robust and compact design
- Precise fixing of the gas nozzle through the clamping prism
- Fast and thorough cleaning of the gas nozzle interior of welding spatters
- Constant distribution of anti-stick agent in the gas nozzle through two spraying nozzles.
- Suitable reamers for all current gas nozzles
- **Option:** wire cutter

Application:

- Perfected for DINSE robotic torch heads
- Fixing variants independent of location
- High availability of the robot through long service life of wearing parts

Torch cleaning station

DIX PRS 600

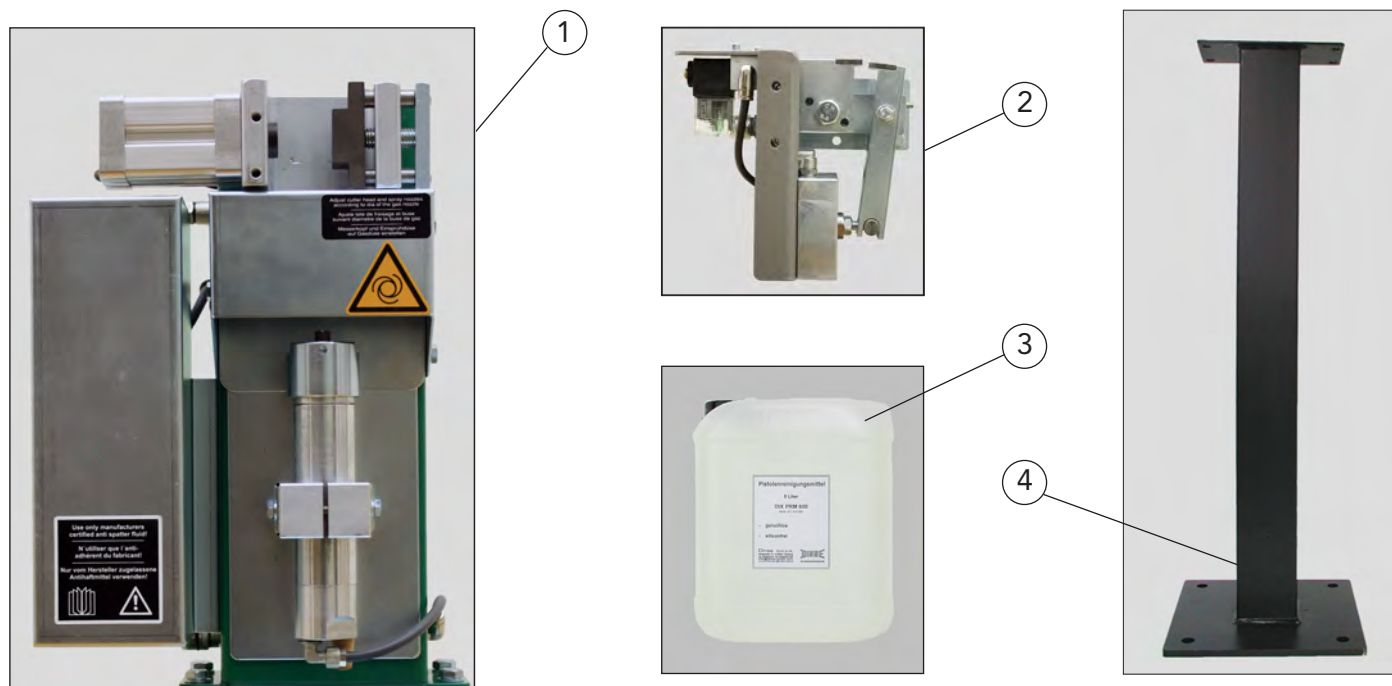

11-00341

subject to change!

11-Robotic-Automatic-Components\J11

Pos.	Description	Part number	Article number
1	Torch cleaning station (with reamer)	DIX PRS 600	811012001
	Options:		
2	Wire cutter (only ready-installed available)	DIX PRA 600	811012006
3	Torch cleaning agent (5 l)	DIX PRM 600	811012002
4	Assembly fixture	DIX PRF 600	811012005

► The corresponding reamer you find in the accessories list!
Variants deviating of the standard fittings on request.



Torch cleaning station

DIX PRS 600

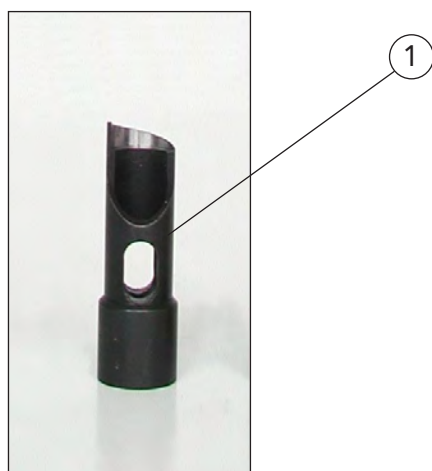

11-00342

subject to change!

11-RoboticAutomaticComponentsU11

Pos.	Description	Dimension A_D / I_D	Part number	Article number
1	Reamer (for DIX 1-3-5209A)	ø 8,5 / 6,2 mm	DIX PRX 650	811012050
	Reamer (for DIX 1-3-5911AK)	ø 10,5 / 8,5 mm	DIX PRX 651	811012051
	Reamer (for DIX 1-3-5212A)	ø 11,0 / 7,0 mm	DIX PRX 652	811012052
	Reamer (for DIX 1-3-5413A)	ø 12,0 / 9,0 mm	DIX PRX 653	811012053
	Reamer (for DIX 1-3-5215A, DIX 1-3-5415A, DIX 1-3-5914, DIX 1-3-5915A)	ø 14,0 / 9,0 mm	DIX PRX 654	811012054
	Reamer (for DIX 1-3-5415A, DIX KMG 115 TR)	ø 14,0 / 11,0 mm	DIX PRX 657	811012057
	Reamer (for DIX KMG 118 TR)	ø 17,0 / 11,0 mm	DIX PRX 662	811012062

A_D - outside diameter
 I_D - inside diameter

► Other reamers on request.



Torch cleaning station

DIX PRS 600

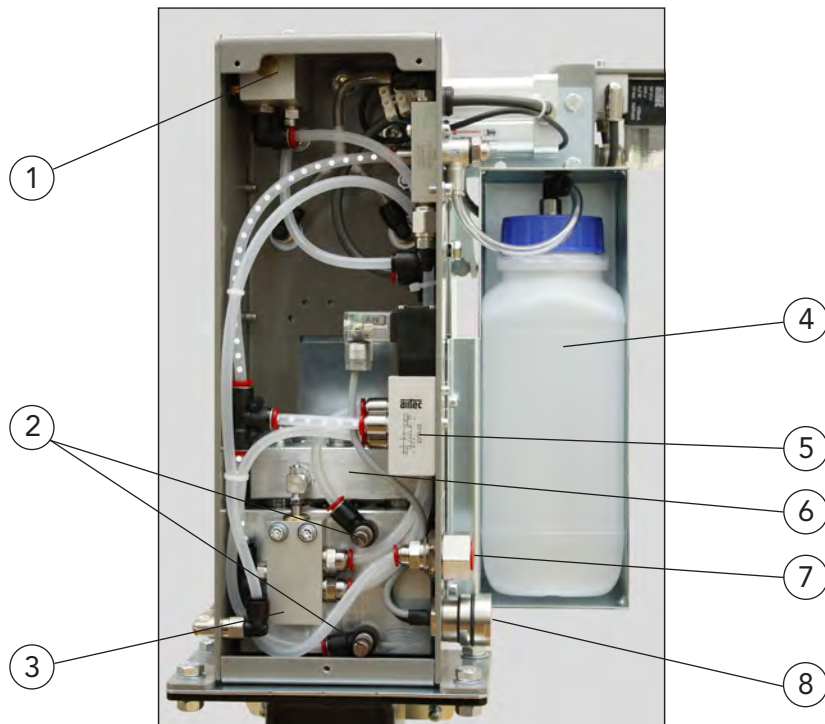

11-00343

subject to change!

11-Robotic-Automatic-Components\J11

Pos.	Description	Part number	Article number
1	Signal contact breaker	DIX PRX 605	811012030
2	Throttle relief valve B	DIX PRX 611	811012017
3	Distributing valve (5/2 way)	DIX PRX 608	811012014
4	Tank	DIX PRX 622	811012028
5	Solenoid valve (with hand operation)	DIX PRX 609	811012015
6	Sliding unit	DIX PRX 610	811012016
7	Air connection (1/4" complete)	DIX PRX 612	811012018
8	Socket (5 pins)	DIX PRX 613	811012019
	Plug (5 pins, without picture)	DIX PRX 614	811012020

Torch cleaning station

DIX PRS 600

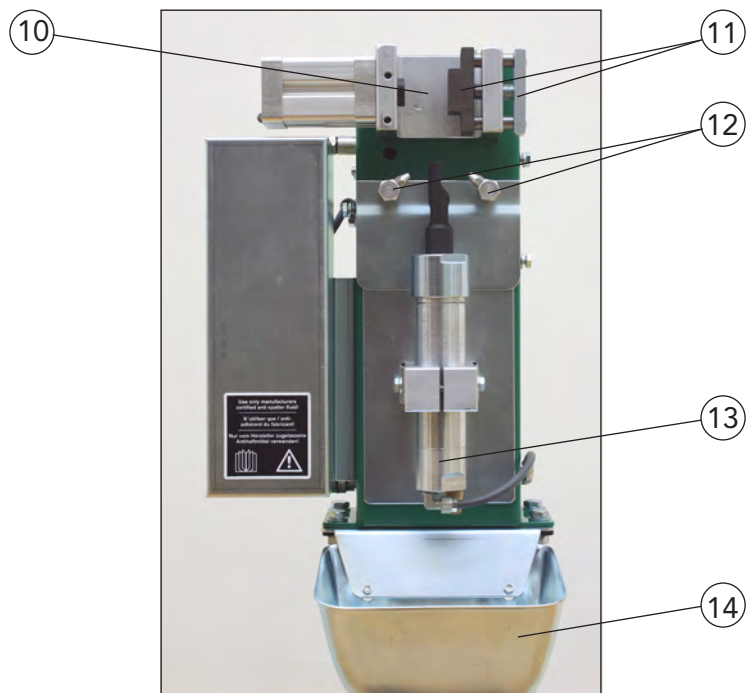

11-00344

subject to change!

11-Robotic-AutomaticComponents\J11

Pos.	Description	Part number	Article number
10	Clamping cylinder,complete	DIX PRX 601	811012007
11	Lock, complete	DIX PRX 604	811012029
12	Spraying nozzle (without picture)	DIX PRX 621	811012027
13	Pneumatic motor	DIX PRX 615	811012021
14	Cup (with bracket)	DIX PRX 603	811012009
	Limit switch (for clamping cylinder back)	DIX PRX 602	811012008

Wire cutter

DIX PRA 600

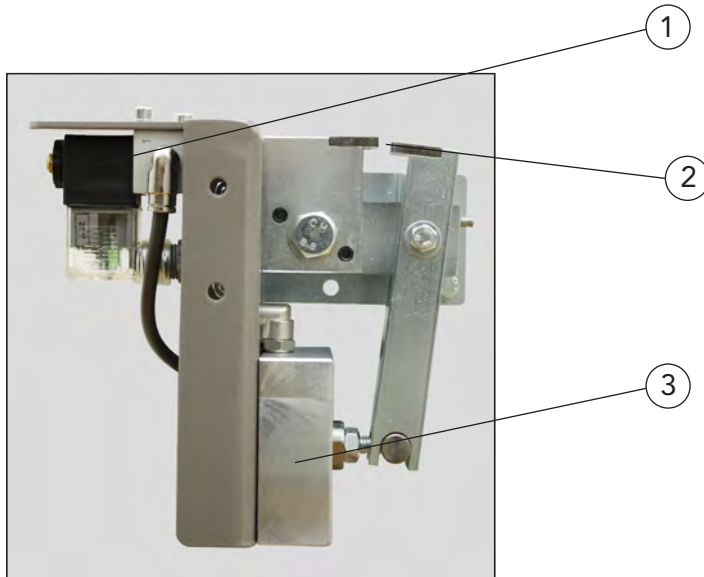

11-00345

subject to change!

11-Robotic-Automatic-Components\J11

Pos.	Description	Part number	Article number
1	Solenoid valve	DIX PRX 623	811012029
2	Knife	DIX PRX 620	811012026
3	Cylinder	DIX PRX 619	811012025

Air cooling unit

DIX UK 500



Options according to range of application

Technical data (IEC 60974-2):

Air cooling unit

Cooling process	Air Forced cooling
Supply voltage	230V / 50 Hz
Mains fuse	16 A
Protection class	IP 23
Cooling capacity	2000 W
max. coolant outlet pressure	3,5 bar
Cooling type	AF
Tank capacity	7 l
Dimensions (L/B/H)	485/390/385 mm
Weight	21 kg



Application:

- For DINSE manual, robotic and automatic torches

Pos. Description

- 1 Air cooling unit
- 2 Coolant, 9,3 l

Part number

- DIX UK 500
- DIX KF 23 E/9,3 l

Article number

- 720000002
- 720000003

Air cooling unit

DIX UK 500



Pos. Description

- 1 Cap
- 2 Hand grip mount
- 3 Hand grip
- 4 Signal light
- 5 Quick release coupling, red
- 6 Main switch
- 7 Quick release coupling, blue

Part number

- DIX UKX 521
- DIX UKX 502
- DIX UKX 503
- DIX UKX 504
- DIX DV-30 RED
- DIX UKX 505
- DIX DV-30 BLUE

Article number

- 720000021
- 720000007
- 720000008
- 720000009
- 719300002
- 720000010
- 719300001

11-00347

11-Robotic-AutomaticComponents\J11 subject to change!

Air cooling unit

DIX UK 500

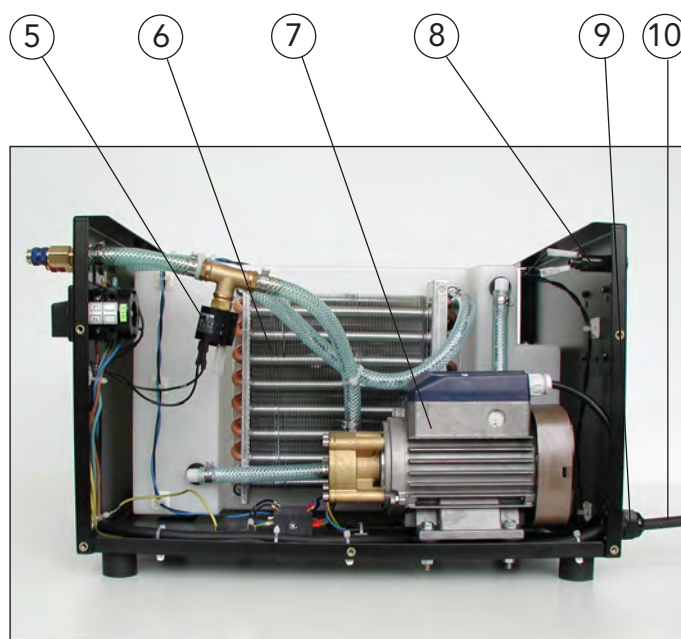
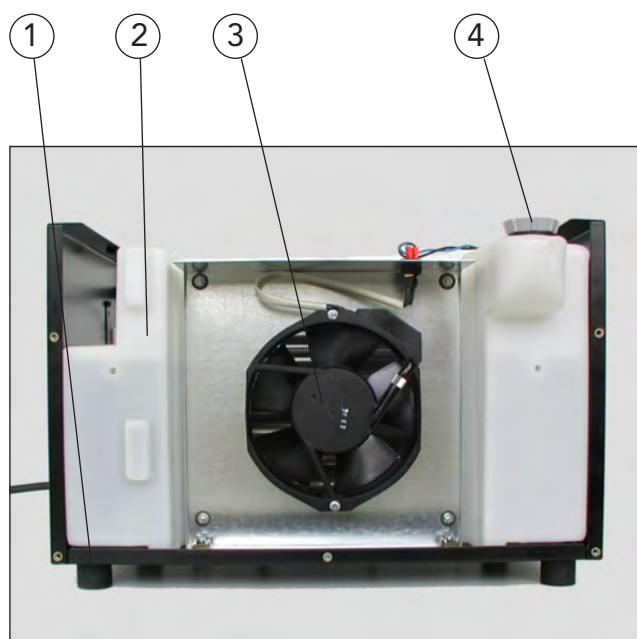

Pos.	Description	Part number	Article number
1	Rubber foot	DIX UKX 506	720000011
2	Tank	DIX UKX 507	720000012
3	Fan	DIX UKX 508	720000013
4	Sealing cover	DIX UKX 509	720000014
5	Pressure monitor	DIX UKX 510	720000015
6	Heat exchanger	DIX UKX 511	720000016
7	Centrifugal pump	DIX UKX 512	720000017
8	Fuse (1.6A slow - blow)	DIX UKX 513	720000018
9	Cable gland	DIX UKX 514	720000019
10	Main cable	DIX UKX 515	720000020

11-00348

subject to change!

11-Robotic-Automatic-Components\J11